

# i Series High Frequency Online UPS

6-10KVA (1ph in/1ph out)  
10-20KVA (3ph in/1ph out)



## Key Features

- User friendly
- Low distortion
- Pure sine wave output
- Double conversion online
- Wide range of input voltage
- Intelligent battery management
- Large blue backlight LCD display
- Automatic alarm; Self-testing function
- Input PFC (power factor correction) technology
- Restart automatically when electricity is restored
- N+X parallel redundancy and capacity expansion for 6K-20K (up to three units)

## Comprehensive Protection

- Output overload
- Short circuit protection
- Static bypass protection
- Under-voltage protection
- Self diagnostics upon boot-up
- Inverter over-temperature protection
- Battery over/under voltage protection

## Intelligent Management

- Optional USB port
- Optional Relay card
- Optional SNMP card
- Supports timing boot up/shut down
- Supports timing UPS self-test function
- Intelligent Power Management Software
- Standard RS232 interface for local monitoring
- Support real time graphical user interface function

Personal  
Computers



Network



Industry



Medical



Telecom



Local area  
Networks



# Trendy & Elegant LCD Design for real-time UPS system information:

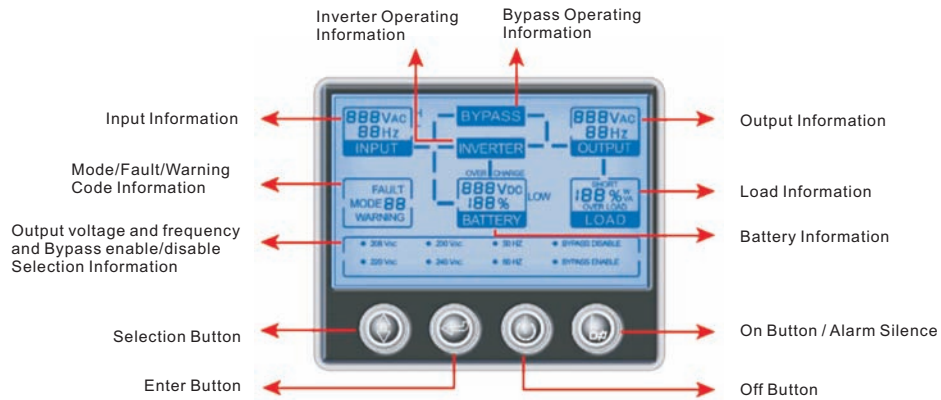

## Back Panel Description:

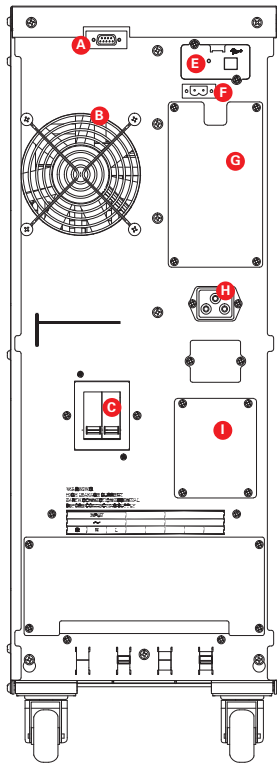

i 6CK

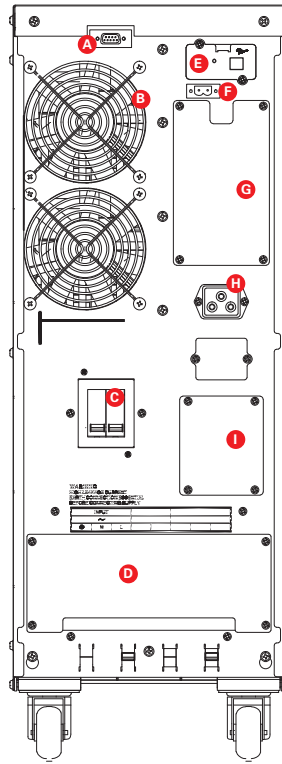

i 10CK

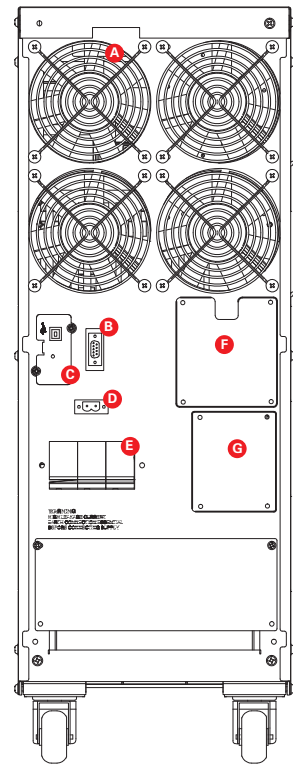

i 15/20CK

- A Communication Port
- B Cooling Fan
- C Input Breaker
- D Terminal Blocks Cover
- E Intelligent Slot /USB Port (Optional)
- F EPO
- G Parallel Port
- H External Battery (For Long Backup Time UPS Only)
- I Maintenance Bypass Switch

- A Communication Port
- B Cooling Fan
- C Input Breaker
- D Terminal Blocks Cover
- E Intelligent Slot /USB Port (Optional)
- F EPO
- G Parallel Port
- H External Battery (For Long Backup Time UPS Only)
- I Maintenance Bypass Switch

- A Fan
- B RS232
- C Intelligent Slot /USB Port(Optional)
- D EPO
- E Input Breaker
- F Parallel Port
- G Maintenance Switch

# i Series High Frequency Online UPS 6-10KVA (1ph in/1ph out)

## i Series Technical Specifications

Model	i series 6-10KVA				
	6CK	6CK-XL	10CK	10CK-XL	
Rated Power	6KVA/4.2KW		10KVA/7KW		
Rated Voltage	220/230/240VAC				
Rated Frequency	50/60 Hz				
Input					
Voltage Range	176~279VAC (±3VAC)				
Frequency Range	50HZ:(46~54HZ);60HZ:(56HZ~64HZ)				
Power Factor	0.98				
Output					
Voltage Regulation	208/220/230/240X (1±2%)VAC				
Frequency Regulation	50/60 Hz±0.05Hz				
Power Factor	0.7/0.8 (Optional) Standard 0.7				
Overload Capability	Linear load <3% Non-linear load <6%				
Overload Capability	105% ~ 130% for 10 min; ≥130% for 1min				
Current Crest Ratio	3 : 1				
Transfer Time	0ms (AC mode→Battery mode)				
Battery					
DC Voltage	240 VDC				
Recharge Time	7hrs to 90% of capacity after full load discharge				
Recharge Current	2A	4.2A	2A	4.2A	
Display					
LCD	Display input/output Voltage, Frequency, Battery voltage, Battery capacity, Loading rate.				
Communication					
Interface	Smart RS232、SNMP card (optional) 、USB (optional)				
Environment					
Operation Temperature	0 ~ 40℃				
Humidity	0 ~ 95% (Non-condensing)				
Storage Temperature	-25℃ ~ 55℃				
Sea Level Elevation	<1500m				
Noise Level (1m)	<55dB				
Physics Characteristic					
Weight (KG)	N.W	79.0	33.5	81.5	36.0
	G.W	87.5	39.5	90.0	42.0
Dimensions : (Wx D x H)mm	260X570X717				

# i Series High Frequency Online UPS 10-20KVA (3ph in/1ph out)

## i Series Technical Specifications

Model	i series 10-20KVA			
	10CK-XL	15CK-XL	20CK-XL	
Rated Power	10KVA/7KW	15KVA/10.5KW	20KVA/14KW	
Rated Voltage	380VAC 3phase with ground			
Rated Frequency	50/60HZ			
Input				
Voltage Range	304 ~ 478VAC ( ±3VAC )			
Frequency Range	50HZ:(46~54HZ);60HZ:(56~64HZ)			
Power Factor	0.98			
Output				
Voltage Regulation	208/220/230/240X (1±2%)VAC			
Frequency Regulation	50/60HZ±0.05 Hz			
Power Factor	0.7/0.8 (optional) standard 0.7			
Voltage Distortion	Linear load < 3% Non-Linear load < 6%			
Overload Capability	105% ~ 130% for 10min; ≥ 30% for 1min			
Current Crest Ratio	3 : 1			
Transfer Time	0ms (AC mode → Battery mode)			
Battery				
DC Voltage	240VDC			
Recharge Current	4.2A			
Display				
LCD	Display input/output Voltage, Frequency, Battery voltage, Battery capacity, Loading rate.			
Communication				
Interface	Smart RS232、SNMP card (optional) 、USB (optional)			
Environment				
Operation Temperature	0 ~ 40 °C			
Humidity	0 ~ 95% (Non-condensing)			
Storage Temperature	-25 °C ~ 55 °C			
Sea Level Elevation	< 1500m			
Noise Level (1m)	< 55dB			
Physics Characteristic				
Weight (KG)	N.W	47.0	51.2	51.2
	G.W	53.0	58.5	58.5
Dimensions : (W x D x H)mm	260X570X717			